



Comhairle Contae  
Ros Comáin  
Roscommon  
County Council



Date: 15<sup>th</sup> November 2017

**To: Mayor and Each Member of Roscommon County Council**

**Disposal of Land under Section 211 of the Planning and Development Act, 2000 (as amended) and in accordance with Section 211 (2) of the Planning and Development Act 2000 (as amended) and Article 206 of the Planning and Development Regulations 2001.**

Roscommon County Council offered for sale by way of tender fourteen rural housing plots throughout the county in July 2017. "Expressions of Interest" and "Offers subject to contract for Purchase" were sought and requested to be submitted to Corporate Services Section, Roscommon County Council, Áras an Chontae, Roscommon up to but not later than 12 .00 noon, Friday, 11<sup>th</sup> August, 2017.

The fourteen rural houses were placed on the market for the following reasons:

1. Unable to get houses tenanted because of their rural locations.
2. Social Housing applicants seeking accommodation in urban areas to be close of amenities / schools/ transport etc.
3. Average Time Re-letting Time (National Oversight and Audit Commission - H3 Service Indicator) very high caused by these voids and difficulty to get tenanted.

Below is the list of rural houses proposed for disposal

House No	Address	Recommend Disposal or On HOLD
0767	BALLINA, DYSART, BALLINASLOE, CO ROSCOMMON	On HOLD *
0632	CARROWBAUN, CASTLEPLUNKETT, CO ROSCOMMON	Recommend Disposal
0604	CARROWGARVE, TIBOHINE, CASTLEREA, CO ROSCOMMON	Recommend Disposal
1235	CLOGHER UPPER, BALLINLOUGH, CO ROSCOMMON	On HOLD *
1005	CLOONLUMNEY, CARRACASTLE, BALLAGHADERREEN, CO ROSCOMMON	On HOLD *
1592	CORSKEAGH, FRENCHPARK, CO ROSCOMMON	Recommend Disposal
0606	CREEVY, LISACUL, CASTLEREA, CO ROSCOMMON	On HOLD *
0841	SITE - GRANGE, CURRAGHABOY, ATHLONE, CO ROSCOMMON	On HOLD *
2207	GRANGEBEG, BOYLE, CO ROSCOMMON	Recommend Disposal
0170	GUBBARUDDA, ARIGNA, CARRICK-ON-SHANNON, CO ROSCOMMON	Recommend Disposal
0885	KILMURRAY, CASTLEPLUNKETT, CASTLEREA, CO ROSCOMMON	Recommend Disposal

1258	LISGALLON, CLOVERHILL, CO ROSCOMMON	Recommend Disposal
2394	LONGFORD UPPER, CASTLEREA, CO ROSCOMMON	Recommend Disposal
0664	SRABRA, ARIGNA, Ck-ON-SHANNON,	Recommend Disposal

**Footnote:**

Five rural houses have some mapping/ boundary / registration issues which need to be resolved and it is proposed to present these for disposal at a date in the future.

Roscommon County Council no longer requires the land for any of its functions and under Section 211 (1) (2) the Consent of the Minister was not sought as the consideration obtained by Roscommon County Council was the best reasonable obtainable and in this case, this was the price that the market was prepared to pay for it.

*For economic reasons and the reasons outlined above, I recommend the disposal of the rural houses as listed in table above.*



Date: 15/11/17

Eugene Cummins  
Chief Executive



Comhairle Contae  
Ros Comáin  
Roscommon  
County Council



15<sup>th</sup> November 2017

To: Each Member of Roscommon County Council.

Dear Councillor

You are hereby notified pursuant to the provisions of Section 211 of the Planning and Development Act 2000 (as amended) and Section 183 of the Local Government Act 2001 of particulars of lands which it is proposed to dispose of at the location in county Roscommon and to the persons set out in the schedule hereunder:

**SCHEDULE**

The Land	The persons from whom the land was acquired	The person to whom the land is to be disposed of	The consideration proposed in respect of the disposal
Circa 0.035 Ha (Area outlined in red on map under Folio RN4133F) in the Townland of Carrowbaun, in the Barony of Castlereaugh, Co. Roscommon.	Western Health Board Merlin Park Co Galway	Thomas & William Kelly Kingsland Boyle Co. Roscommon	€5,500.00

Mise le meas

Desmond O'Dwyer  
Senior Executive Officer  
Housing Business Unit

576450 mE, 776390 mN



The Property Registration Authority  
An tÚdarás Clárúcháin Maoinne  
Folio: RN4133F

This map should be read in conjunction with the folio.

Registry maps are based on OSI topographic mapping. Where registry maps are printed at a scale that is larger than the OSI published scale, accuracy is limited to that of the original OSI map scale.

For details of the terms of use and limitations as to scale, accuracy and other conditions relating to Land Registry maps, see [www.orai.ie](http://www.orai.ie).

This map incorporates Ordnance Survey Ireland (OSI) mapping data under a licence from OSI. Copyright © OSI and Government of Ireland.

(centre-line of parcel(s) edged)

- Freehold
- Leasehold
- SubLeasehold

### CAR

Burdens (may not all be represented on map)

- Right of Way / Wayleave
- Turbary
- Pipeline
- Well
- Pump
- Septic Tank
- Soak Pit



A full list of burdens and their symbology can be found at: [www.landireg.ie](http://www.landireg.ie)

**The registry operates a non-conclusive boundary system. The Registry Map identifies properties not boundaries meaning neither the description of land in a register nor its identification by reference to a registry map is conclusive as to the boundaries or extent.** (see Section 85 of the Registration of Title Act, 1964). As inserted by Section 62 of the Registration of Deed and Title Act 2006.



1:2500 Scale

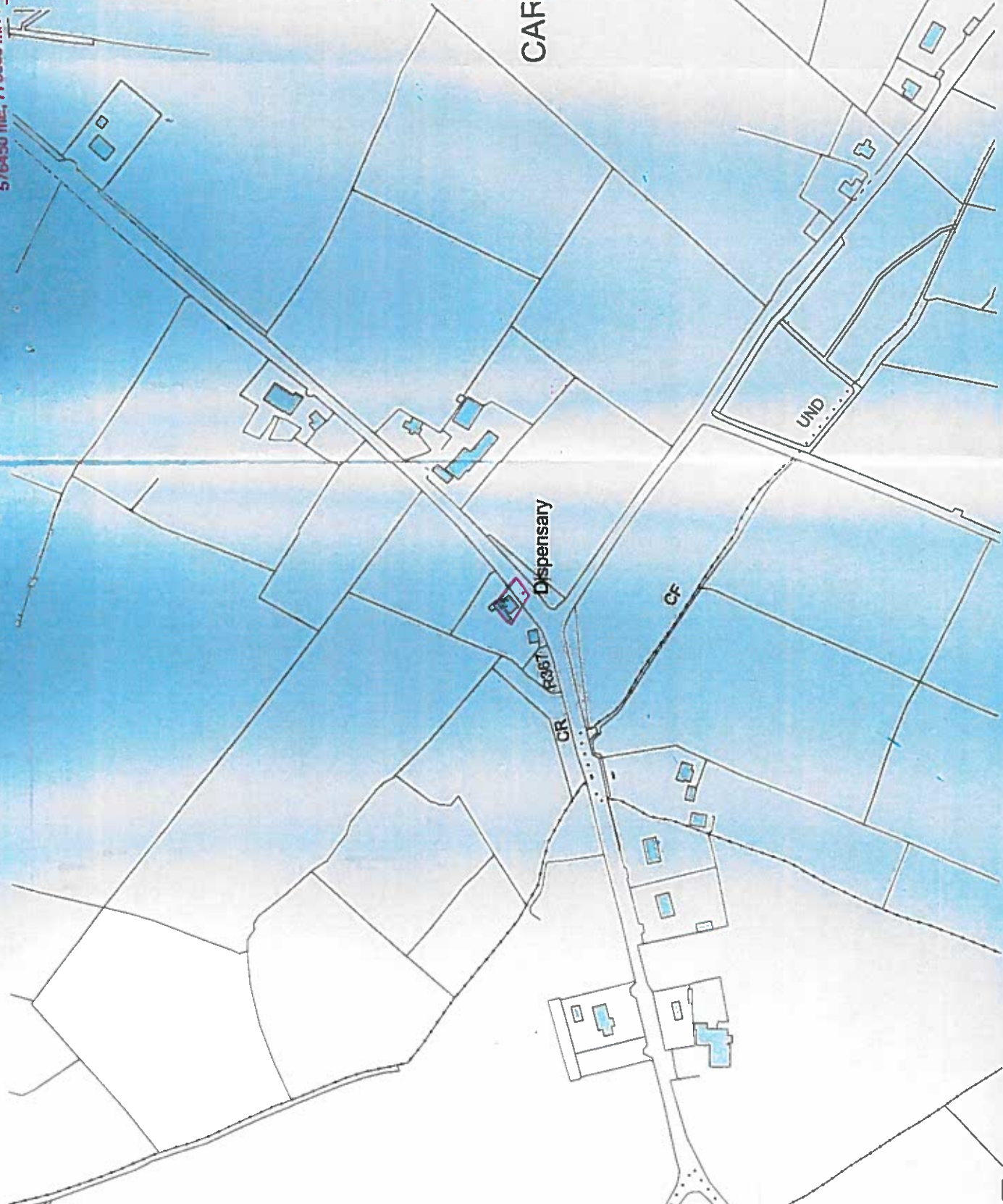



Comhairle Contae  
Ros Comáin  
Roscommon  
County Council



15<sup>th</sup> November 2017

To: Each Member of Roscommon County Council,

Dear Councillor

You are hereby notified pursuant to the provisions of Section 211 of the Planning and Development Act 2000 (as amended) and Section 183 of the Local Government Act 2001 of particulars of lands which it is proposed to dispose of at the location in county Roscommon and to the person set out in the schedule hereunder:

SCHEDULE

The Land	The persons from whom the land was acquired	The person to whom the land is to be disposed of	The consideration proposed in respect of the disposal
0.20 Ha (Area outlined in red on map under Folio RN1627F) in the Townland of Carrowgarve, in the Barony of Frenchpark, Castlerea, Co Roscommon	Joseph Ward Carrowgarve Tibohine Castlerea Co Roscommon	Linda Joyce Willsbrook Castlerea Co Roscommon	€17,550.00

Mise le meas

*Desmond O'Dwyer*

Desmond O'Dwyer  
Senior Executive Officer  
Housing Business Unit

The Property  
Registration Authority  
An tÚdarás  
Cíárúcháin Maoinne  
Folio: RN1627F





This map should be read in conjunction with the folio.

Registry maps are based on OSI topographic mapping. Where registry maps are printed at a scale that is larger than the OSI published scale, accuracy is limited to that of the original OSI map scale.

For details of the terms of use and limitations as to scale, accuracy and other conditions relating to Land Registry maps, see [www.pral.ie](http://www.pral.ie)

This map incorporates Ordnance Survey Ireland (OSI) mapping data under a licence from OSI. Copyright © OSI and Government of Ireland.

(centre-line of parcel(s) edged)

-  Freehold
-  Leasehold
-  SubLeasehold

Burdens (may not all be represented on map)

-  Right of Way / Madaire
-  Turbary
-  Pipeline
-  Well
-  Pump
-  Septic Tank
-  Soak Pit



A full list of burdens and their symbology can be found at: [www.landireg.ie](http://www.landireg.ie)

**The registry operates a non-conclusive boundary system. The Registry Map identifies properties not boundaries meaning neither the description of land in a register nor its identification by reference to a registry map is conclusive as to the boundaries or extent.** (see Section 85 of the Registration of Title Act, 1964). As inserted by Section 62 of the Registration of Deed and Title Act 2006.



15<sup>th</sup> November 2017

To: Each Member of Roscommon County Council.

Dear Councillor

You are hereby notified pursuant to the provisions of Section 211 of the Planning and Development Act 2000 (as amended) and Section 183 of the Local Government Act 2001 of particulars of lands which it is proposed to dispose of at the location in county Roscommon and to the persons set out in the schedule hereunder:

SCHEDULE

The Land	The persons from whom the land was acquired	The person to whom the land is to be disposed of	The consideration proposed in respect of the disposal
0.5770 Ha (Area outlined in red on map under Folio RN10466F & 0.0274 Ha outlined in red on map under Folio RN20944F) in the Townland of Corskeagh and Barony of Frenchpark, Co Roscommon	Doris Greenwood Corskeagh Frenchpark Co Roscommon	Thomas & William Kelly Kingsland Boyle Co. Roscommon	€38,000.00

Mise le meas



---

**Desmond O'Dwyer**  
Senior Executive Officer  
Housing Business Unit



The Property  
Registration Authority  
An tÚdarás  
Clárúcháin Maoine

Folio: RN10466F

This map should be read in conjunction with the folio.

Registry maps are based on OSI topographic mapping. Where registry maps are printed at a scale that is larger than the OSI published scale, accuracy is limited to that of the original OSI map scale.

For details of the terms of use and limitations as to scale, accuracy and other conditions relating to Land Registry maps, see [www.pra.ie](http://www.pra.ie)

This map incorporates Ordnance Survey Ireland (OSI) mapping data under a licence from OSI. Copyright © OSI and Government of Ireland.

(centre-line of parcel(s) edged)

-  Freehold
-  Leasehold
-  SubLeasehold

Burdens (may not all be represented on map)

-  Right of Way / Wayleave
-  Turbary
-  Pipeline
-  Well
-  Pump
-  Septic Tank
-  Soak Pit



A full list of burdens and their symbology can be found at: [www.landdirect.ie](http://www.landdirect.ie)

**The registry operates a non-conclusive boundary system. The Registry Map identifies properties not boundaries meaning neither the description of land in a register nor its identification by reference to a registry map is conclusive as to the boundaries or extent.** (see Section 85 of the Registration of Title Act, 1964). As inserted by Section 62 of the Registration of Deed and Title Act 2006.

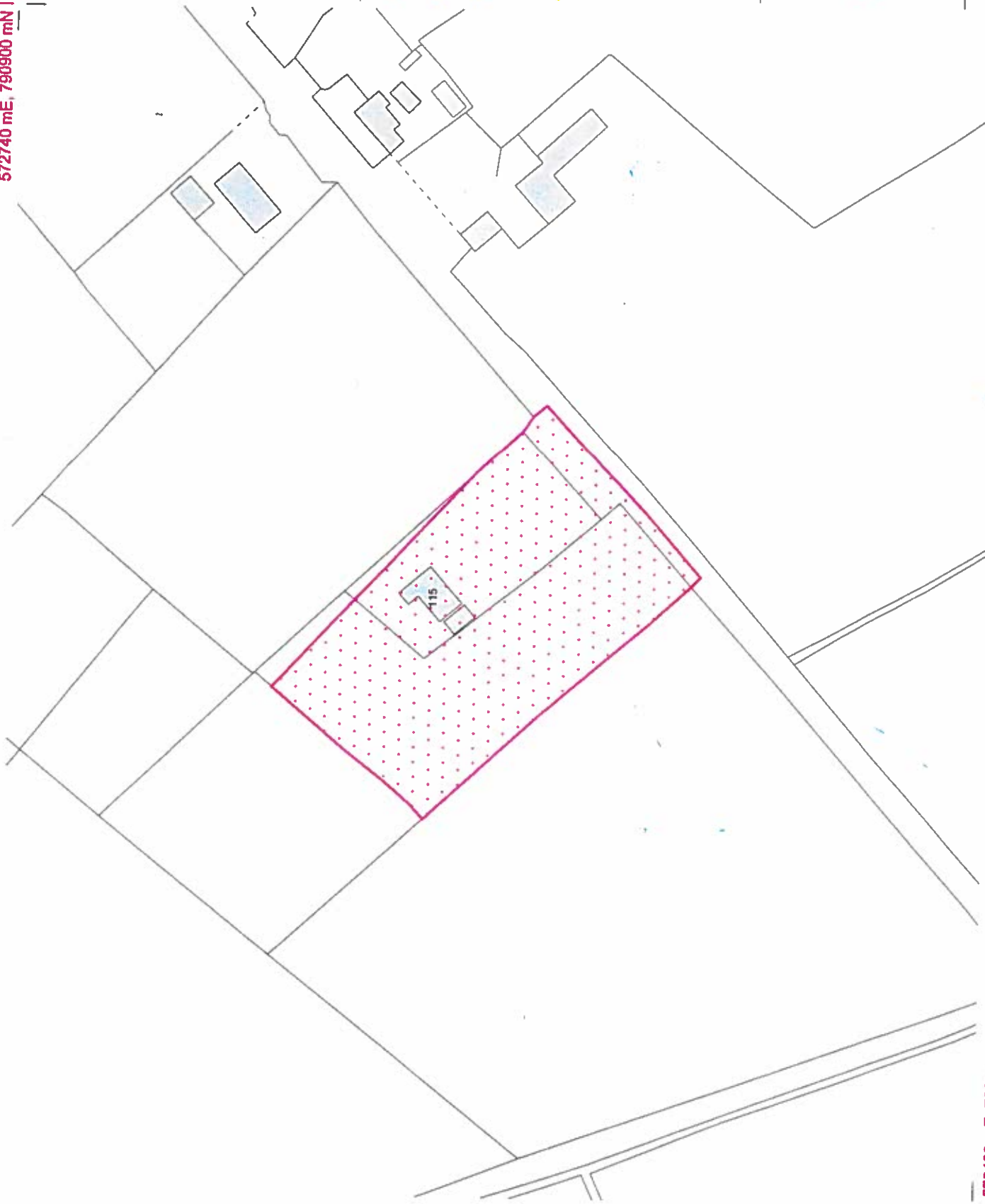



Folio Number: RN20944F

Application Number: P2017LR089791Y

572750 mE, 790930 mN |  
The Property  
Registration Authority  
An tÚdarás  
Clárúcháin Maoine  
Folio: RN20944F



This map should be read in conjunction with the folio.

Registry maps are based on OSI topographic mapping. Where registry maps are printed at a scale that is larger than the OSI published scale, accuracy is limited to that of the original OSI map scale.

For details of the terms of use and limitations as to scale, accuracy and other conditions relating to Land Registry maps, see [www.orai.ie](http://www.orai.ie)

This map incorporates Ordnance Survey Ireland (OSI) mapping data under a licence from OSI. Copyright © OSI and Government of Ireland.

(centre-line of parcel(s) edged)

Freehold

Leasehold

Subleasehold

Burdens (may not all be represented on map)

- Right of Way / Wayleave
- Turbary
- Pipeline
- Well
- Pump
- Septic Tank
- Soak Pit



A full list of burdens and their symbology can be found at: [www.landdirect.ie](http://www.landdirect.ie)

**The registry operates a non-conclusive boundary system. The Registry Map identifies properties not boundaries meaning neither the description of land in a register nor its identification by reference to a registry map is conclusive as to the boundaries or extent.** (see Section 85 of the Registration of Title Act, 1964). As inserted by Section 62 of the Registration of Deed and Title Act 2006.

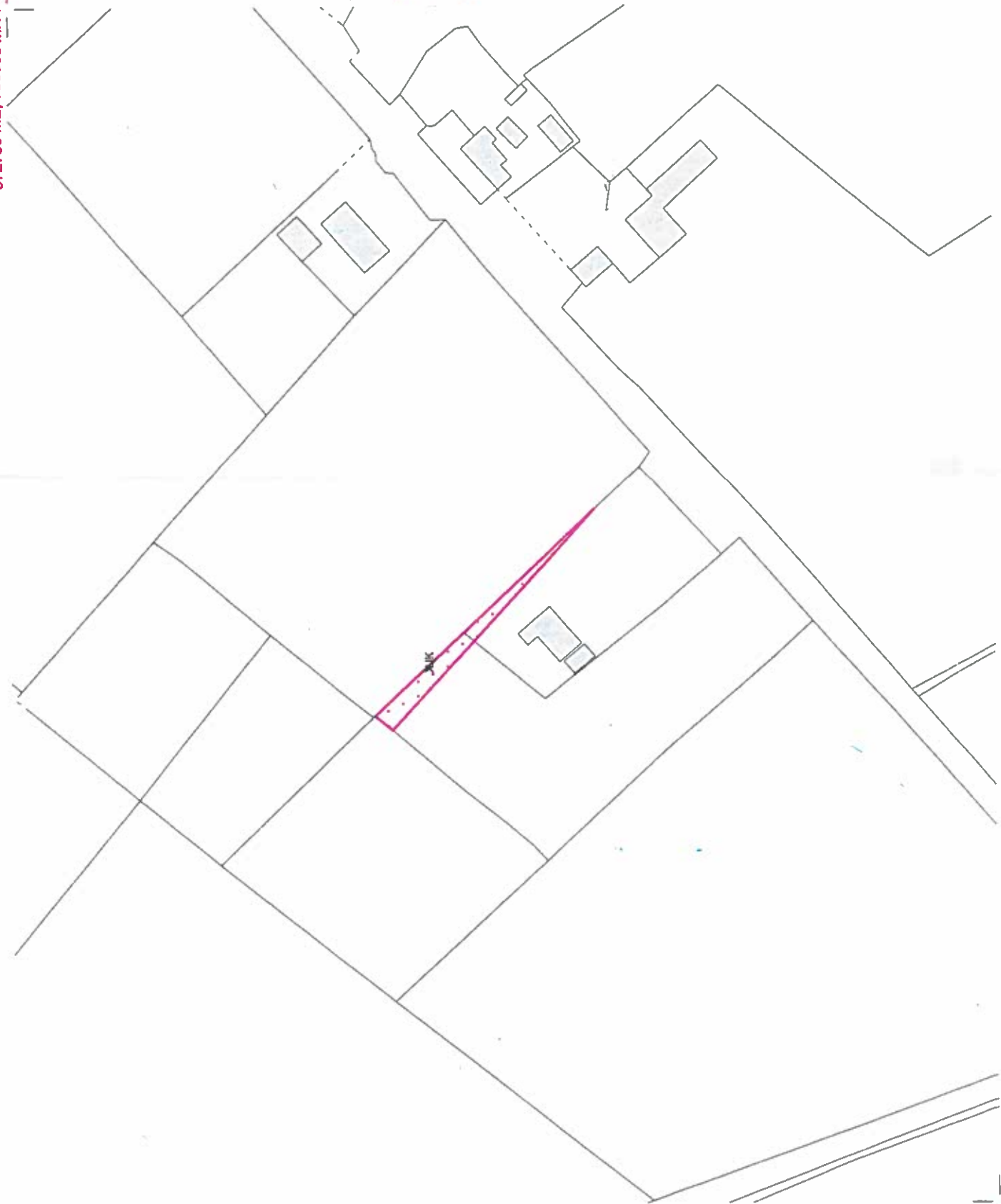



Comhairle Contae  
Ros Comáin  
Roscommon  
County Council



15<sup>th</sup> November 2017

To: Each Member of Roscommon County Council.

Dear Councillor

You are hereby notified pursuant to the provisions of Section 211 of the Planning and Development Act 2000 (as amended) and Section 183 of the Local Government Act 2001 of particulars of lands which it is proposed to dispose of at the location in county Roscommon and to the persons set out in the schedule hereunder:

**SCHEDULE**

The Land	The persons from whom the land was acquired	The person to whom the land is to be disposed of	The consideration proposed in respect of the disposal
0.15 Ha (Area outlined in red on map under Folio RN16328F) in the Townland of Grangebeg, in the Barony of Boyle, Co Roscommon	John & Kate Connelly (nee Hawkins) Grangebeg Boyle Co Roscommon	Michael Cunningham & Helena Casey 5 Phoenix House Boyle Co. Roscommon	€22,500.00

Mise le meas

Desmond O'Dwyer  
Senior Executive Officer  
Housing Business Unit

Application Number: P2017LR089794C  
 590180 mE, 800710 mN | The Property  
 Registration Authority  
 An tÚdarás  
 Clárúcháin Maoine  
 Folio: RN16328F



This map should be read in conjunction with the folio.

Registry maps are based on OSI topographic mapping. Where registry maps are printed at a scale that is larger than the OSI published scale, accuracy is limited to that of the original OSI map scale.

For details of the terms of use and limitations as to scale, accuracy and other conditions relating to Land Registry maps, see [www.pra.ie](http://www.pra.ie).

This map incorporates Ordnance Survey Ireland (OSI) mapping data under a licence from OSI. Copyright © OSI and Government of Ireland.

(centre-line of parcel(s) edged)

- Freehold
- Leasehold
- SubLeasehold

Burdens (may not all be represented on map)

- Right of Way / Wayleave
- Turbary
- Pipeline
- Well
- Pump
- Septic Tank
- Soak Pit



A full list of burdens and their symbology can be found at: [www.landireg.ie](http://www.landireg.ie)

**The registry operates a non-conclusive boundary system. The Registry map identifies properties not boundaries meaning neither the description of land in a register nor its identification by reference to a registry map is conclusive as to the boundaries or extent.** (see Section 85 of the Registration of Title Act, 1964). As inserted by Section 62 of the Registration of Deed and Title Act 2006.

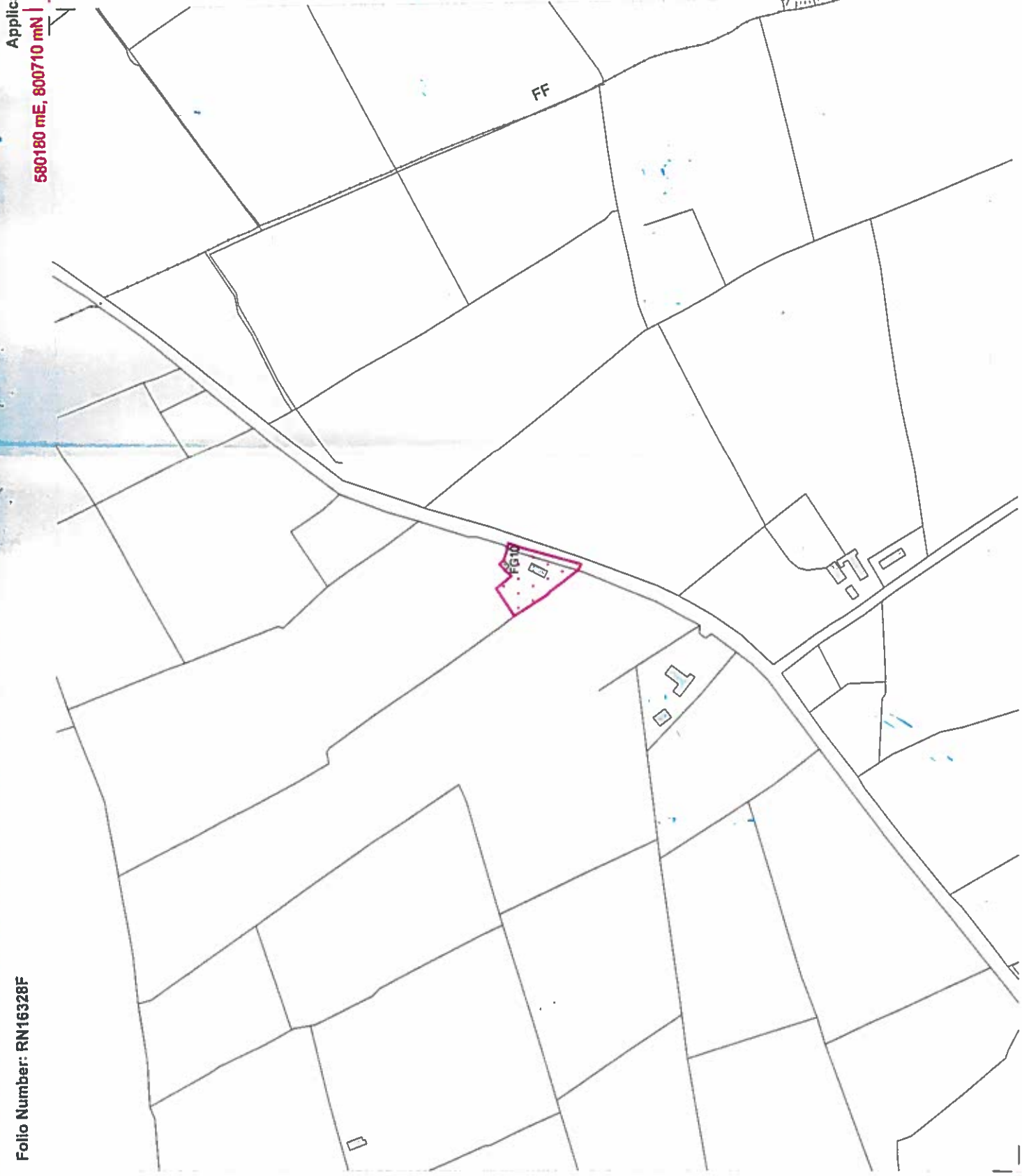

Folio Number: RN16328F

570390 mE 800710 mN

1:2500 Scale



15<sup>th</sup> November 2017

To: Each Member of Roscommon County Council.

**Disposal of Land – Section 211 of the Planning and Development Act, 2000 (as amended)**

Notice under Section 211 of the Planning and Development Act 2000 (as amended) and under Section 183 of the Local Government Act 2001 – to dispose of land at Gubbarudda, Arigna, Carrick-on-Shannon, CO. Roscommon to Thomas & William Kelly, Kingsland, Boyle, Co. Roscommon

Dear Councillor,

You are hereby notified, in accordance with the provision of Section 183 of the Local Government Act 2001, of the particulars of the land, set out in the schedule hereunder, that Roscommon County Council proposes to dispose of, under Section 211 of the Planning and Development Act, 2000 (as amended) and in accordance with Section 211 (2) of the Planning and Development Act 2000 (as amended) and Article 206 of the Planning and Development Regulations 2001.

**SCHEDULE**

The Land	The persons from whom the land was acquired	The person to whom the land is to be disposed of	The consideration proposed in respect of the disposal
0.28 Ha (Area outlined in red on map under Folio RN41285F) in the Townland of Gubbarudda in the Barony of Boyle, Co Roscommon	Owen Duignan Gubbarudda Arigna Carrick-on-Shannon Co Roscommon	Thomas & William Kelly Kingsland Boyle Co. Roscommon	€16,500.00

Mise le meas,



**Desmond O'Dwyer**  
Senior Executive Officer  
Housing Business Unit

589920 mE, 816530 mN | The Property Registration Authority  
An tUdarás Clárúcháin Maoine  
Folio: RN41285F



This map should be read in conjunction with the folio.

Registry maps are based on OSI topographic mapping. Where registry maps are printed at a scale that is larger than the OSI published scale, accuracy is limited to that of the original OSI map scale.

For details of the terms of use and limitations as to scale, accuracy and other conditions relating to Land Registry maps, see [www.pral.ie](http://www.pral.ie)

This map incorporates Ordnance Survey Ireland (OSI) mapping data under a licence from OSI. Copyright © OSI and Government of Ireland.

- (centre-line of parcel(s) edged)
- Freehold
- Leasehold
- Subleasehold

**Burdens** (may not all be represented on map)

- Right of Way / Wayleave
- Turbary
- Pipeline
- Well
- Pump
- Septic Tank
- Soak Pit

A full list of burdens and their symbology can be found at: [www.landdirect.ie](http://www.landdirect.ie)

**The registry operates a non-conclusive boundary system. The Registry Map identifies properties not boundaries meaning neither the description of land in a register nor its identification by reference as to the boundaries or extent.** (see Section 85 of the Registration of Title Act, 1964). As inserted by Section 62 of the Registration of Deed and Title Act 2006.

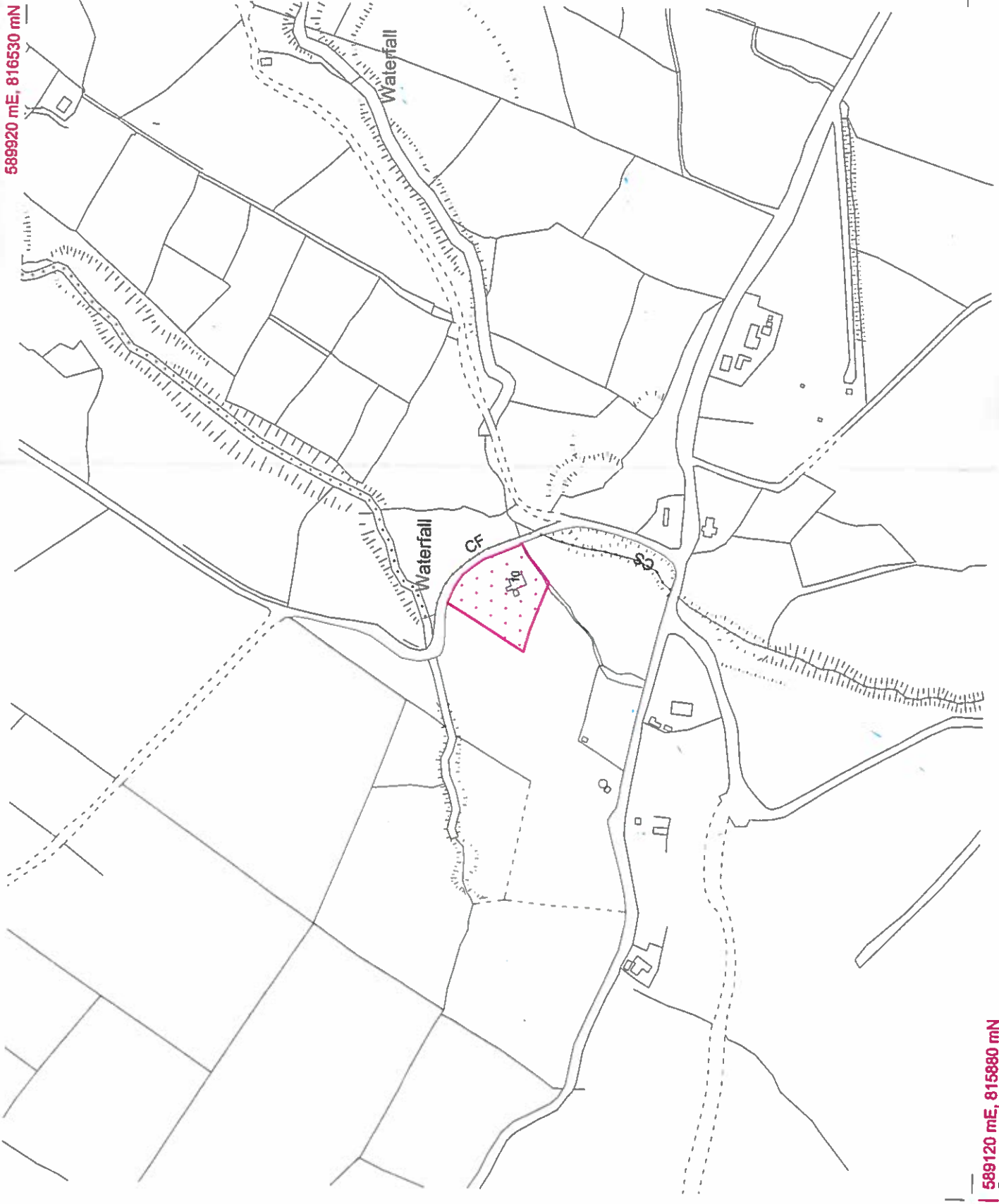

15<sup>th</sup> November 2017

To: Each Member of Roscommon County Council.

Dear Councillor

You are hereby notified pursuant to the provisions of Section 211 of the Planning and Development Act 2000 (as amended) and Section 183 of the Local Government Act 2001 of particulars of lands which it is proposed to dispose of at the location in county Roscommon and to the persons set out in the schedule hereunder:

**SCHEDULE**

The Land	The persons from whom the land was acquired	The person to whom the land is to be disposed of	The consideration proposed in respect of the disposal
0.43 Ha (Area outlined in red on map under Folio RN14370) in the Townland of Kilmurray, in the Barony of Castlerea, Castleplunkett, Co Roscommon.	Donal O'Rourke V.S., Castlerea Co. Roscommon	John & Annette Donlon Keelogue Creggs Co. Roscommon	€20,600.00

Mise le meas



Desmond O'Dwyer  
Senior Executive Officer  
Housing Business Unit

575590 mE, 781760 mN



The Property Registration Authority  
An tÚdarás  
Clárúcháin Maoine

Folio: RN14370

This map should be read in conjunction with the folio.

Registry maps are based on OSI topographic mapping. Where registry maps are printed at a scale that is larger than the OSI published scale, accuracy is limited to that of the original OSI map scale.

For details of the terms of use and limitations as to scale, accuracy and other conditions relating to Land Registry maps, see [www.ortli.ie](http://www.ortli.ie).

This map incorporates Ordnance Survey Ireland (OSI) mapping data under a licence from OSI. Copyright © OSI and Government of Ireland.

(centre-line of parcel(s) edged)

Freehold

Leasehold

SubLeasehold

Burdens (may not all be represented on map)

Right of Way / Wayleave

Turbary

Pipeline

Well

Pump

Septic Tank

Soak Pit



A full list of burdens and their symbology can be found at: [www.landdirect.ie](http://www.landdirect.ie)

**The registry operates a non-conclusive boundary system. The Registry Map identifies properties not boundaries meaning neither the description of land in a register nor its identification by reference to a registry map is conclusive as to the boundaries or extent.** (see Section 85 of the Registration of Title Act, 1964). As inserted by Section 62 of the Registration of Deed and Title Act 2006.

1:2500 Scale

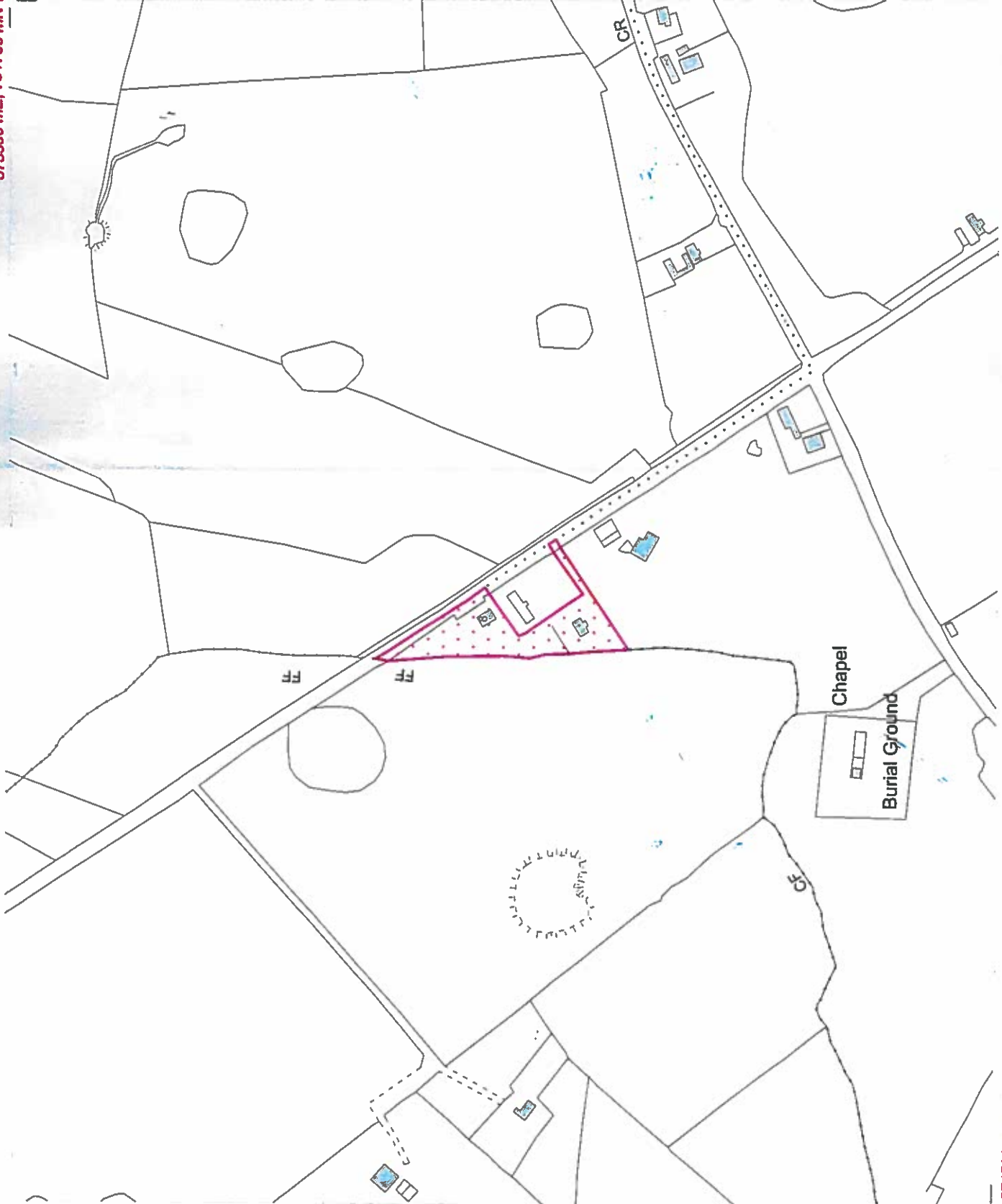



Comhairle Contae  
Ros Comáin  
Roscommon  
County Council



15<sup>th</sup> November 2017

To: Each Member of Roscommon County Council.

**Disposal of Land – Section 211 of the Planning and Development Act, 2000 (as amended)**

Notice under Section 211 of the Planning and Development Act 2000 (as amended) and under Section 183 of the Local Government Act 2001 – to dispose of land at Lisagallon, Cloverhill, Co Roscommon to Thomas & William Kelly, Kingsland, Boyle, Co. Roscommon.

Dear Councillor,

You are hereby notified, in accordance with the provision of Section 183 of the Local Government Act 2001, of the particulars of the land, set out in the schedule hereunder, that Roscommon County Council proposes to dispose of, under Section 211 of the Planning and Development Act, 2000 (as amended) and in accordance with Section 211 (2) of the Planning and Development Act 2000 (as amended) and Article 206 of the Planning and Development Regulations 2001.

**SCHEDULE**

The Land	The persons from whom the land was acquired	The person to whom the land is to be disposed of	The consideration proposed in respect of the disposal
0.13 Ha (Area outlined in red on map under Folio RN2997F) in the Townland of Lisagallon in the Barony of Athlone North, Cloverhill, Co Roscommon	Brian & Eileen Kelly Lisgallon Cloverhill Co. Roscommon	Thomas & William Kelly Kingsland Boyle Co. Roscommon	€22,000.00

Mise le meas,

**Desmond O'Dwyer**  
Senior Executive Officer  
Housing Business Unit





The Property  
Registration Authority  
An tÚdarás  
Clárúcháin Maoine  
Folio: RN2997F

This map should be read in conjunction with the folio.

Registry maps are based on OSI topographic mapping. Where registry maps are printed at a scale that is larger than the OSI published scale, accuracy is limited to that of the original OSI map scale.

For details of the terms of use and limitations as to scale, accuracy and other conditions relating to Land Registry maps, see [www.landireg.ie](http://www.landireg.ie)

This map incorporates Ordnance Survey Ireland (OSI) mapping data under a licence from OSI. Copyright © OSI and Government of Ireland.

(centre-line of parcel(s) edged)

-  Freehold
-  Leasehold
-  SubLeasehold

Burdens (may not all be represented on map)

-  Right of Way / Wayleave
-  Turbary
-  Pipeline
-  Well
-  Pump
-  Septic Tank
-  Soak Pit



A full list of burdens and their symbology can be found at: [www.landdirect.ie](http://www.landdirect.ie)

**The registry operates a non-conclusive boundary system. The Registry Map identifies properties not boundaries meaning neither the description of land in a register nor its identification by reference to a registry map is conclusive as to the boundaries or extent.** (see Section 95 of the Registration of Title Act, 1964). As inserted by Section 62 of the Registration of Deed and Title Act 2006.

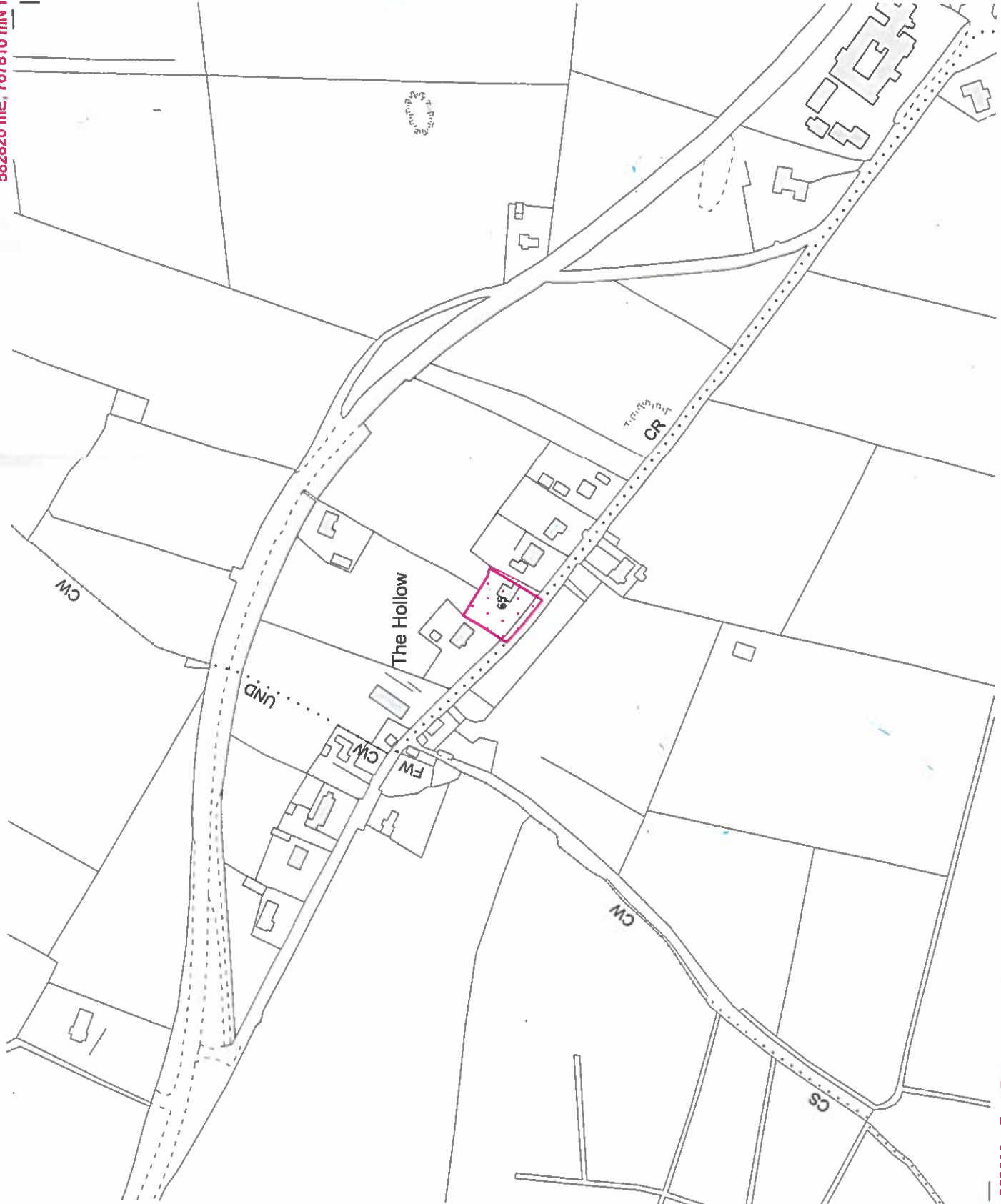

15<sup>th</sup> November 2017

To: Each Member of Roscommon County Council.

**Disposal of Land – Section 211 of the Planning and Development Act, 2000 (as amended)**

Notice under Section 211 of the Planning and Development Act 2000 (as amended) and under Section 183 of the Local Government Act 2001 – to dispose of land at Longford Upper, Castlerea, Co. Roscommon to Desmond & Christina Egan, Longford Upper, Castlerea, Co. Roscommon.

Dear Councillor,

You are hereby notified, in accordance with the provision of Section 183 of the Local Government Act 2001, of the particulars of the land, set out in the schedule hereunder, that Roscommon County Council proposes to dispose of, under Section 211 of the Planning and Development Act, 2000 (as amended) and in accordance with Section 211 (2) of the Planning and Development Act 2000 (as amended) and Article 206 of the Planning and Development Regulations 2001.

**SCHEDULE**

The Land	The persons from whom the land was acquired	The person to whom the land is to be disposed of	The consideration proposed in respect of the disposal
Circa 0.22 Ha (Area outlined in red on map under Folio RN30744F) in the Townland of Longford Upper in the Barony of Castlerea, Co Roscommon	Ingrid Chadwick Longford Upper Castlerea Co Roscommon	Desmond & Christina Egan Longford Upper Castlerea Co. Roscommon	€36,500.00

Mise le meas,



**Desmond O'Dwyer**  
Senior Executive Officer  
Housing Business Unit

Application Number: C2015LR024976M  
 569710 mE, 778410 mN | The Property  
 Registration Authority  
 An tÚdarás  
 Clárúcháin Maoinne  
 Folio: RN30744F



This map should be read in conjunction with the folio.

Registry maps are based on OSI topographic mapping. Where registry maps are printed at a scale that is larger than the OSI published scale, accuracy is limited to that of the original OSI map scale.

For details of the terms of use and limitations as to scale, accuracy and other conditions relating to Land Registry maps, see [www.landireg.ie](http://www.landireg.ie).

This map incorporates Ordnance Survey Ireland (OSI) mapping data under a licence from OSI. Copyright © OSI and Government of Ireland.

- (centre-line of parcels) edged)
- Freehold
  - Leasehold
  - SubLeasehold

- Burdens (may not all be represented on map)
- Right of Way / Wayleave
  - Turbary
  - Pipeline
  - Well
  - Pump
  - Septic Tank
  - Soak Pit

A full list of burdens and their symbology can be found at: [www.landireg.ie](http://www.landireg.ie)

**The registry operates a non-conclusive boundary system. The Registry Map identifies properties not boundaries meaning neither the description of land in a register nor its identification by reference to a registry map is conclusive as to the boundaries or extent.** (see Section 85 of the Registration of Title Act, 1964). As inserted by Section 62 of the Registration of Deed and Title Act 2005.



1:1000 Scale

Folio Number: RN30744F

569710 mE, 778410 mN

13.09.2015 14:33:13

Application Number: C2015LR024976M





Comhairle Contae  
Ros Comáin  
Roscommon  
County Council



15<sup>th</sup> November 2017

To: Each Member of Roscommon County Council.

Dear Councillor

You are hereby notified pursuant to the provisions of Section 211 of the Planning and Development Act 2000 (as amended) and Section 183 of the Local Government Act 2001 of particulars of lands which it is proposed to dispose of at the location in county Roscommon and to the persons set out in the schedule hereunder:

**SCHEDULE**

The Land	The persons from whom the land was acquired	The person to whom the land is to be disposed of	The consideration proposed in respect of the disposal
0.42 Ha (Area outlined in red on map under Folio RN40979F) in the Townland of Srabra in the Barony of Boyle, Co Roscommon	Charles Mc Dermott Srabra Arigna Carrick on Shannon Co Roscommon	P Mc Manus Construction Building Contractors Carrack Na Brack Drumshanbo Co. Leitrim	€21,000.00

Mise le meas

Desmond O'Dwyer  
Senior Executive Officer  
Housing Business Unit

593530 mE, 818040 mN



The Property Registration Authority  
An tÚdarás  
Clárúcháin Maoine

Folio: RN40979F

This map should be read in conjunction with the folio.

Registry maps are based on OSI topographic mapping. Where registry maps are printed at a scale that is larger than the OSI published scale, accuracy is limited to that of the original OSI map scale.

For details of the terms of use and limitations as to scale, accuracy and other conditions relating to Land Registry maps, see [www.prai.ie](http://www.prai.ie)

This map incorporates Ordnance Survey Ireland (OSI) mapping data under a licence from OSI. Copyright © OSI and Government of Ireland.

(centre-line of parcel(s) edged)

Freehold

Leasehold

SubLeasehold

Burdens (may not all be represented on map)

Right of Way / Wayleave

Turbary

Pipeline

Well

Pump

Septic Tank

Soak Pit

A full list of burdens and their symbology can be found at: [www.landdirect.ie](http://www.landdirect.ie)

The registry operates a non-conclusive boundary system. The Registry Map identifies properties not boundaries meaning neither the description of land in a register nor its identification by reference to a registry map is conclusive as to the boundaries or extent. (see Section 85 of the Registration of Title Act, 1964). As inserted by Section 62 of the Registration of Deed and Title Act 2006.

